



FICHE D'HOMOLOGATION / HOMOLOGATION FORM



COMMISSION
INTERNATIONALE
DE KARTING - FIA

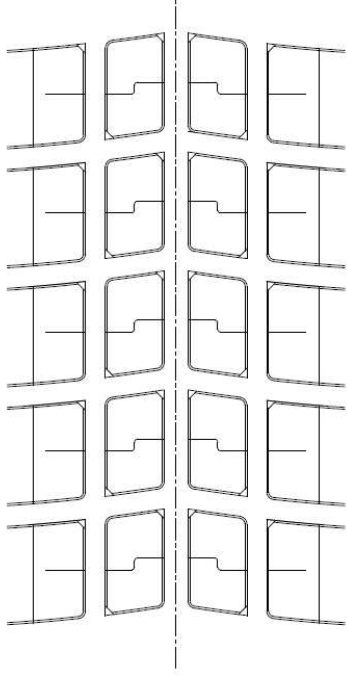

PNEUMATIQUE / TYRE 5" SLICK MINI / WET MINI

Constructeur / <i>Manufacturer</i>	VEGA S.r.l.
Marque / <i>Make</i>	VEGA
Modèle / <i>Model</i>	WM1 CIK MINI 10X4.00-5
Catégorie / <i>Category</i>	GRUPE 3 / GROUP 3
Durée de l'homologation / <i>Validity of the Homologation</i>	3 ans / 3 years
Nombre de pages / <i>Number of pages</i>	4
La présente Fiche d'Homologation reproduit descriptions, illustrations et dimensions du pneumatique au moment de l'homologation CIK-FIA et du test d'homologation.	<i>This Homologation Form reproduces descriptions, illustrations and dimensions of the tyre at the moment of the CIK-FIA homologation and of the homologation test.</i>
	
Photo du pneu monté sur la jante / <i>Photo of the tyre fitted to the rim</i>	Dessin de la bande de roulement / <i>Tread design drawing</i>
SIGNATURE ET TAMPON DE L'ASN / SIGNATURE AND STAMP OF THE ASN	SIGNATURE ET TAMPON DE LA CIK-FIA / SIGNATURE AND STAMP OF THE CIK-FIA
	

DESCRIPTIONS TECHNIQUES	TECHNICAL DESCRIPTIONS
Sous une température de 23°C +/-2°C, avec une humidité de 50% +/-5%	At a temperature of 23°C +/-2°C and with a humidity of 50% +/-5%

Pt	Descriptions / Descriptions	Valeurs / Value		Tolérances / Tolerances	
1	Dimensions / Dimensions	10x4.00-5		--	
2	Désignation du mélange / Tread compound designation	WM1		--	
3	Pression de service / Service pressure	1 bar		+/- 0.3 bar	
4	Pression de gonflage / Inflation pressure	4 bar		max	
5	Capacité de charge / Load capacity	80 kg		max	
6	Vitesse maximale / Maximum speed	140 km/h			
7	Rigidité latérale et verticale (sous charge de 40 kg) / Lateral and vertical stiffness (under 40 kg load)	L = 2 , V = 20mm		L: +/-1 V: +/-2	
8					
9	Profondeur du profil / Depth of tread	4.7 mm		+/- 0.5 mm	
10	Poids en grammes / Weight in grams	835gr		+/- 10%	
11	Nombre de plis / Numbers of plies	2		--	
12	Épaisseur de la bande de roulement / Tread thickness	5 mm		+/- 1.0 mm	
13	Nombre d'indicateurs d'usure du pneu / Number of tread wear indicators	--		--	
14	Matériau de la carcasse / Carcass material	NYLON		--	
15	Angle de tissage de la toile du pneu / Angle of tyre canvas	31		+/- 3°	
16	Type de fil de tissage (selon ISO) / Canvas thread type (according to ISO)	940		--	
17	Pneu tubeless / Tubeless tyre	YES		--	
18	Dureté superficielle de la bande de roulement (ISO 48:1010 – 2 échantillons de 2 mm d'épaisseur) / Superficial tread hardness (ISO 48:1010 – 2 samples of 2 mm thickness)			+/- 5 DIDC - IRHD	
19	Contrainte-déformation en traction (ISO 37:2017 – éprouvette type 3) / Tensile stress-strain (ISO 37:2017 – type 3 sample)	à / at 100%	à / at 300%	à / at 100%	à / at 300%
				+/- 0.5 MPa	+/- 0.8 MPa
20	Largeur de la bande / Tread width			Avant/Front : max. 80 mm / Arrière/Rear : max. 120 mm	

DESSIN	DRAWING
--------	---------

Dessin du pneu en section transversale et dimensions du pneu monté sur une jante / <i>Drawing of tyre cross section and dimensions of the tyre fitted to a rim</i>	Dimensions / <i>Dimensions</i>	Tolérances / <i>Tolerances</i>
	mm	+/- X mm
	\varnothing 126.2 *	+0/-1.0
	\varnothing 255 mm	+/-5
	115 mm	+/-5
	75 mm	+/- 5
	105 mm	+/- 5
*Dimension selon Dessin Technique N° 4 jante 5" standardisée / <i>Dimension according to Technical Drawing N° 4 standardised 5" rim</i>		

DESSIN TECHNIQUE N°4

Jante 5"

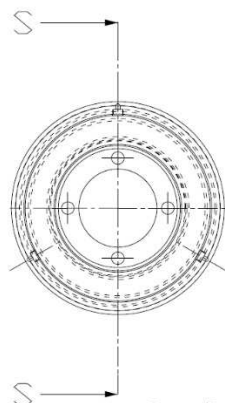



Cotes en/Dimensions in mm

TECHNICAL DRAWING No. 4

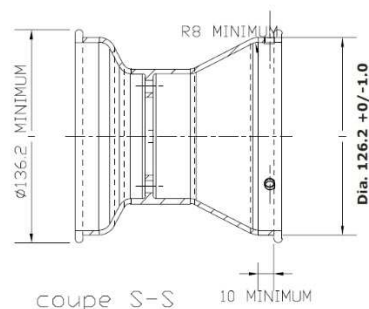
5" Rim



coupe S-S

PHOTOS ET INSCRIPTIONS	PHOTOS AND INSCRIPTIONS																																			
Seules les inscriptions sur le flanc extérieur du pneu qui ne changeront pas tout au long de la fabrication sont reportées ci-dessous.	<i>Only the inscriptions on the tyre external sidewall that will remain unchanged during production are mentioned below.</i>																																			
Photo du flanc extérieur du pneu / <i>Photo of tyre external sidewall</i>	Inscription sur le flanc extérieur du pneu / <i>Inscriptions on tyre external sidewall</i>																																			
	<table border="1"> <thead> <tr> <th data-bbox="799 730 1141 792">Texte / Text</th> <th data-bbox="1144 730 1310 792">Hauteur / Height</th> <th data-bbox="1313 730 1481 792">Trait / Stroke</th> </tr> </thead> <tbody> <tr> <td data-bbox="799 797 1141 837">VEGA (printed)</td> <td data-bbox="1144 797 1310 837"></td> <td data-bbox="1313 797 1481 837"></td> </tr> <tr> <td data-bbox="799 842 1141 882">KART >></td> <td data-bbox="1144 842 1310 882">9.5 mm</td> <td data-bbox="1313 842 1481 882">2.8/4 mm</td> </tr> <tr> <td data-bbox="799 887 1141 927">10 x 4.00 – 5</td> <td data-bbox="1144 887 1310 927">6.5 mm</td> <td data-bbox="1313 887 1481 927">3 mm</td> </tr> <tr> <td data-bbox="799 931 1141 1016">Max inflation pressure 4 bar</td> <td data-bbox="1144 931 1310 1016">3.8 mm</td> <td data-bbox="1313 931 1481 1016">1 mm</td> </tr> <tr> <td data-bbox="799 1021 1141 1061">Barcode (printed)</td> <td data-bbox="1144 1021 1310 1061"></td> <td data-bbox="1313 1021 1481 1061"></td> </tr> <tr> <td data-bbox="799 1066 1141 1106"></td> <td data-bbox="1144 1066 1310 1106"></td> <td data-bbox="1313 1066 1481 1106"></td> </tr> <tr> <td data-bbox="799 1111 1141 1151"></td> <td data-bbox="1144 1111 1310 1151"></td> <td data-bbox="1313 1111 1481 1151"></td> </tr> <tr> <td data-bbox="799 1155 1141 1196"></td> <td data-bbox="1144 1155 1310 1196"></td> <td data-bbox="1313 1155 1481 1196"></td> </tr> <tr> <td data-bbox="799 1200 1141 1240"></td> <td data-bbox="1144 1200 1310 1240"></td> <td data-bbox="1313 1200 1481 1240"></td> </tr> </tbody> </table>	Texte / Text	Hauteur / Height	Trait / Stroke	VEGA (printed)			KART >>	9.5 mm	2.8/4 mm	10 x 4.00 – 5	6.5 mm	3 mm	Max inflation pressure 4 bar	3.8 mm	1 mm	Barcode (printed)																			
	Texte / Text	Hauteur / Height	Trait / Stroke																																	
	VEGA (printed)																																			
	KART >>	9.5 mm	2.8/4 mm																																	
	10 x 4.00 – 5	6.5 mm	3 mm																																	
	Max inflation pressure 4 bar	3.8 mm	1 mm																																	
	Barcode (printed)																																			
Photo du flanc intérieur du pneu / <i>Photo of tyre internal sidewall</i>	Inscription sur le flanc intérieur du pneu / <i>Inscriptions on tyre internal sidewall</i>																																			
	<table border="1"> <thead> <tr> <th data-bbox="799 1485 1141 1547">Texte / Text</th> <th data-bbox="1144 1485 1310 1547">Hauteur / Height</th> <th data-bbox="1313 1485 1481 1547">Trait / Stroke</th> </tr> </thead> <tbody> <tr> <td data-bbox="799 1552 1141 1592">VEGA</td> <td data-bbox="1144 1552 1310 1592">13 mm</td> <td data-bbox="1313 1552 1481 1592">3/8 mm</td> </tr> <tr> <td data-bbox="799 1597 1141 1637">10 x 4.00 – 5</td> <td data-bbox="1144 1597 1310 1637">6.5 mm</td> <td data-bbox="1313 1597 1481 1637">3 mm</td> </tr> <tr> <td data-bbox="799 1641 1141 1682">Made in Italy</td> <td data-bbox="1144 1641 1310 1682">3.8 mm</td> <td data-bbox="1313 1641 1481 1682">1 mm</td> </tr> <tr> <td data-bbox="799 1686 1141 1727">Tubless</td> <td data-bbox="1144 1686 1310 1727">3.8 mm</td> <td data-bbox="1313 1686 1481 1727">1 mm</td> </tr> <tr> <td data-bbox="799 1731 1141 1816">For racing purpose only</td> <td data-bbox="1144 1731 1310 1816">3.8 mm</td> <td data-bbox="1313 1731 1481 1816">1 mm</td> </tr> <tr> <td data-bbox="799 1821 1141 1861">WM1</td> <td data-bbox="1144 1821 1310 1861">8.5 mm</td> <td data-bbox="1313 1821 1481 1861">3.5 mm</td> </tr> <tr> <td data-bbox="799 1865 1141 1906">CIK Mini</td> <td data-bbox="1144 1865 1310 1906">5 mm</td> <td data-bbox="1313 1865 1481 1906">2 mm</td> </tr> <tr> <td data-bbox="799 1910 1141 1951">Barcode (printed)</td> <td data-bbox="1144 1910 1310 1951"></td> <td data-bbox="1313 1910 1481 1951"></td> </tr> <tr> <td data-bbox="799 1955 1141 1995"></td> <td data-bbox="1144 1955 1310 1995"></td> <td data-bbox="1313 1955 1481 1995"></td> </tr> <tr> <td data-bbox="799 2000 1141 2040"></td> <td data-bbox="1144 2000 1310 2040"></td> <td data-bbox="1313 2000 1481 2040"></td> </tr> </tbody> </table>	Texte / Text	Hauteur / Height	Trait / Stroke	VEGA	13 mm	3/8 mm	10 x 4.00 – 5	6.5 mm	3 mm	Made in Italy	3.8 mm	1 mm	Tubless	3.8 mm	1 mm	For racing purpose only	3.8 mm	1 mm	WM1	8.5 mm	3.5 mm	CIK Mini	5 mm	2 mm	Barcode (printed)										
	Texte / Text	Hauteur / Height	Trait / Stroke																																	
	VEGA	13 mm	3/8 mm																																	
	10 x 4.00 – 5	6.5 mm	3 mm																																	
	Made in Italy	3.8 mm	1 mm																																	
	Tubless	3.8 mm	1 mm																																	
	For racing purpose only	3.8 mm	1 mm																																	
	WM1	8.5 mm	3.5 mm																																	
	CIK Mini	5 mm	2 mm																																	
	Barcode (printed)																																			